



16 Wilman Way, Salisbury, Wiltshire, SP2 8QS

*** VIEWINGS ON HOLD DUE TO HIGH DEMAND***

- DETACHED FOUR BEDROOM FAMILY HOUSE
- EN-SUITE SHOWER ROOM
- SITTING ROOM DINING ROOM AND CONSERVATORY
- STUDY / OFFICE
- FITTED KITCHEN
- UTILITY ROOM
- DRIVE WAY PARKING FOR 2 CARS
- COUNCIL TAX BAND E
- EPC - C

£1,500 PCM

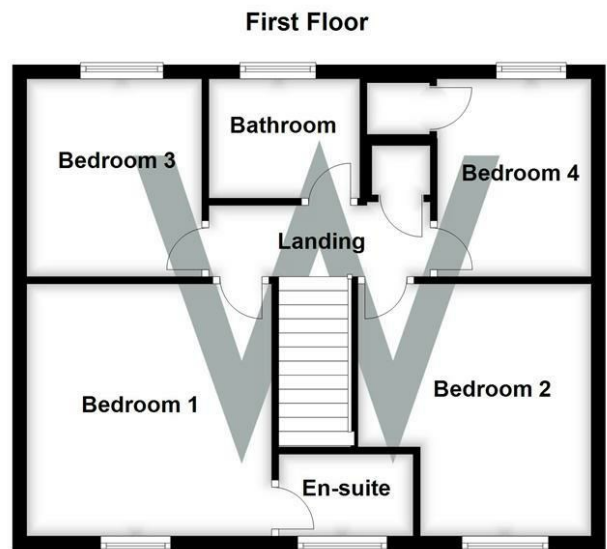
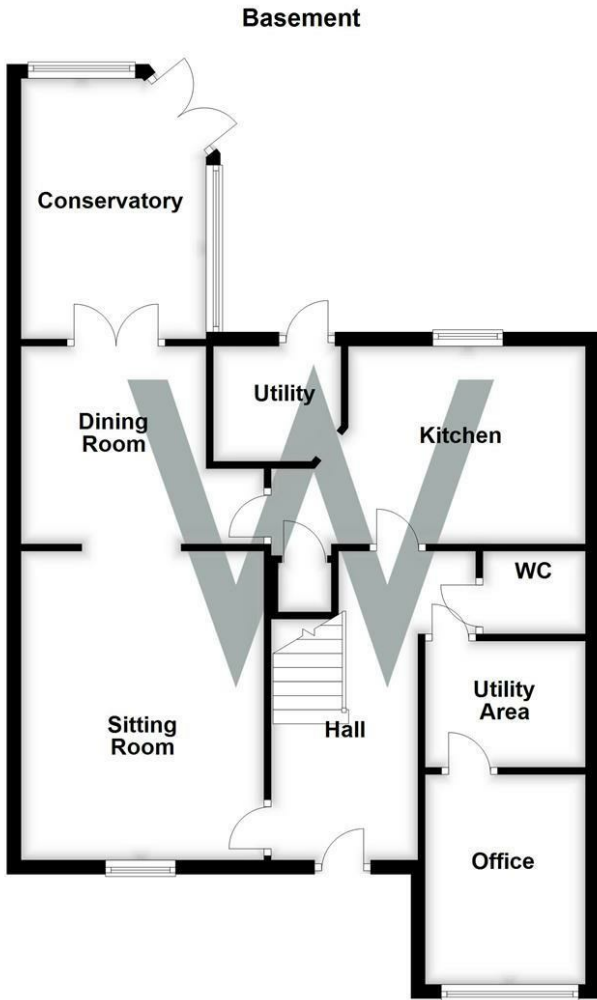

WHITES

Castle Chambers, 47 Castle Street, Salisbury,
 Wiltshire, SP1 3SP
 Tel: 01722 336422/Option 2
 www.hwwhite.co.uk
 email: lettings-management@hwwhites.co.uk

Energy Efficiency Rating		Current	Potential
Very energy efficient - lower running costs			
(92 plus) A			
(81-91) B			
(69-80) C			
(55-68) D			
(39-54) E			
(21-38) F			
(1-20) G			
Not energy efficient - higher running costs			
		71	83
England & Wales		EU Directive 2002/91/EC	

Environmental Impact (CO ₂) Rating		Current	Potential
Very environmentally friendly - lower CO ₂ emissions			
(92 plus) A			
(81-91) B			
(69-80) C			
(55-68) D			
(39-54) E			
(21-38) F			
(1-20) G			
Not environmentally friendly - higher CO ₂ emissions			
England & Wales		EU Directive 2002/91/EC	